

Lithium Iron Phosphate (LiFePO₄) Battery

Specifications

Electrical Characteristics	Nominal Voltage	12.8V
	Rated Capacity	20AH
	Series X Parallel Maximum	2S X 4P
	Circuit Protection	Over charge, Over discharge, Over current, Over temp, Short, Balance
	Cycle Life	>2000 cycles at 0.2C 100% DOD
	Monthly Self Discharge	Less than 2%
	Efficiency of Charge	100% @ 0.5C (when used with proper LiFePO ₄ charger)
	Efficiency of Discharge	96 ~ 99% @ 1C
Charge	Charge Voltage	14.4 ± 0.2V
	Standard Charge Current	4A
	Max. Charge Current	20A
Discharge	Std. Discharge Current	4A
	Max. Continuous Current	20A
	Discharge Cut-off Voltage	~9V
Environmental	Charge Temperature	0°C to 55°C (32°F to 131°F) at 60 ± 25% Relative Humidity
	Discharge Temperature	-20°C to 60°C (-4°F to 140°F) at 60 ± 25% Relative Humidity
	Storage Temperature	-20°C to 45°C (-4°F to 113°F) at 60 ± 25% Relative Humidity
Mechanical	Cell Material	LiFePO ₄
	Case / IP Class	Plastic / IP65
	Dimensions (in / mm)	7.13 x 3.03 x 6.61 (6.61 HT) / 181 x 77 x 168 (168 HT)
	Approx. Weight (lbs /kg)	5.07/ 2.3
	Terminal Type	M5
Optional	Extended Functions	Power Switch, SOC indicator, USB, Communications (CANBUS, Bluetooth, SMBUS, RS485, RS232, UART, I ² C)

* Use ZEUS matching PCCG-LFP14.4V5A LiFePO₄ or PCCGLFP14.4V10A LiFePO₄ charger to achieve optimum performance

**Modular design enables deployment of up to two batteries in series and up to four batteries in parallel.



Physical Dimensions

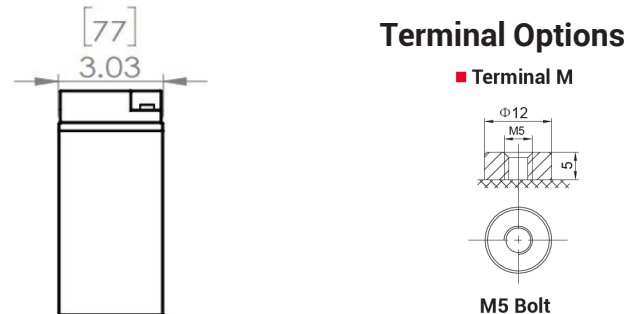
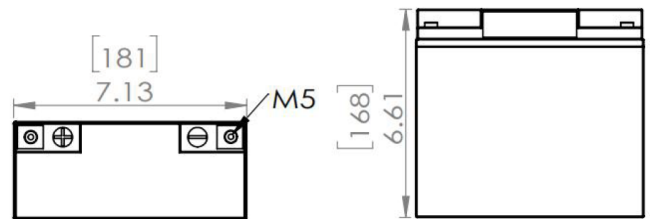

Terminal Options

■ Terminal M

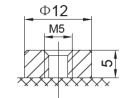

M5 Bolt

Discharge Characteristics

